

TECHNICAL SPECIFICATION SHEET FOR

## Icematic JET Line Ice Maker

**JET20M** Medium ice cubes 35mm dia x H 31mm, 20g



- Self contained medium sized ice cube machine with built-in storage bin
- **20.5kg** daily production rate
- **18** ice cubes per cycle
- **8kg** storage bin capacity
- Air cooled condensing unit
- Electromechanical controls
- Horizontal spray technology to produce pure, crystal clear ice cubes
- Bin sensor stops ice production when the bin is full
- Built-in Agion antimicrobial protection for better sanitation
- Stainless steel external body
- Insulated bin door and ice storage bin minimises air condensation and water formation on equipment surfaces
- Front ventilation for improved yield even in critical install requirements
- Moffat IM101000 single stage triple action filtration system, including head and brass fittings
- Includes ice scoop

Note: Ice production rate is measured with the water temperature at 10°C and an ambient temperature of 21°C.

TECHNICAL SPECIFICATION SHEET FOR

## Icematic JET Line Ice Maker JET20M

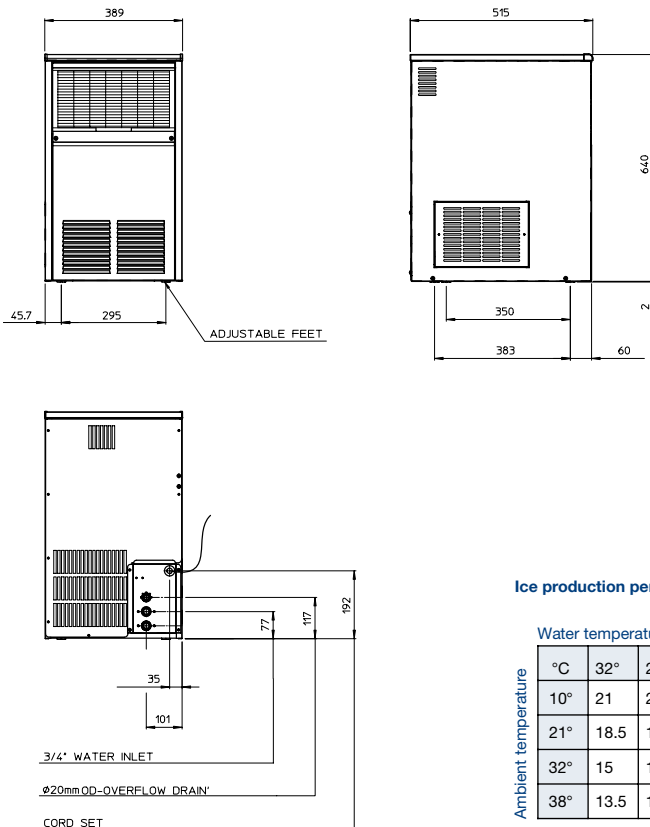

### Ice production per 24 hours

Water temperature		32°	21°	15°	10°	
Ambient temperature	10°	21	22	22.5	23	kg
	21°	18.5	19.5	20	20.5	kg
	32°	15	16	16.5	17	kg
	38°	13.5	14.5	15	15.5	kg

### JET20M

#### Dimensions

Width: 389mm  
Height: 640mm  
Depth: 515mm  
Nett weight: 31kg  
Packed weight: 36kg

#### Ice cube production dimension

Medium ice: Ø 35mm x H 31mm, 20g

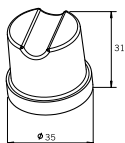

#### Water consumption

Air cooled version: 3 litres per hour

#### Electrical rating

Air cooled version: 220-240V, 1P+N+E, 50Hz, 310W, 10A cordset fitted

#### Refrigerant type

R134a

#### Installation distance from wall

- rear 150mm
- right 150mm
- left 150mm

Placement of unit should be indoors in an environment that does not exceed the air and water temperature limitations of the unit

#### Water connection requirements

Inlet connection: R ¾"  
Cold water (5-35°C)  
Pressure (1-5 bar)  
Water outlet connection: Ø 20mm

**MOFFAT®**

moffat.com.au  
moffat.co.nz

Australia

Moffat Pty Limited

Victoria/Tasmania

740 Springvale Road  
Mulgrave, Victoria 3170  
Telephone 03-9518 3888  
Facsimile 03-9518 3833  
vsales@moffat.com.au

New South Wales

Telephone 02-8833 4111  
nswsales@moffat.com.au

South Australia

Telephone 03-9518 3888  
vsales@moffat.com.au

Queensland

Telephone 07-3630 8600  
qldsales@moffat.com.au

Western Australia

Telephone 08-9202 6820  
bgarcia@moffat.com.au

New Zealand

Moffat Limited

Christchurch

16 Osborne Street  
Christchurch 8011  
Telephone 03-389 1007  
Facsimile 03-389 1276  
sales@moffat.co.nz

Auckland

Telephone 09-574 3150  
sales@moffat.co.nz

#### Disclaimer:

All unit capacities are based on subjective testing. Moffat accepts no liability for production values.



In line with policy to continually develop and improve its products, Moffat Limited reserves the right to change specifications and design without notice.

© Copyright Moffat Ltd  
Moffat 05.13



TECHNICAL SPECIFICATION SHEET FOR

## Icematic JET Line Ice Maker

**JET30M** Medium ice cubes 35mm dia x H 31mm, 20g

**JET30S** Small ice cubes 26mm dia x H 23mm, 8g



- Self contained medium sized ice cube machine with built-in storage bin
- **27kg** daily production rate
- **24** ice cubes per cycle
- **15kg** storage bin capacity
- Air cooled condensing unit
- Electromechanical controls
- Horizontal spray technology to produce pure, crystal clear ice cubes
- Bin sensor stops ice production when the bin is full
- Built-in Agion antimicrobial protection for better sanitation
- Stainless steel external body
- Insulated bin door and ice storage bin minimises air condensation and water formation on equipment surfaces
- Front ventilation for improved yield even in critical install requirements
- Moffat IM101000 single stage triple action filtration system, including head and brass fittings
- Includes ice scoop

Note: Ice production rate is measured with the water temperature at 10°C and an ambient temperature of 21°C.

TECHNICAL SPECIFICATION SHEET FOR

## Icematic JET Line Ice Maker JET30M | JET30S

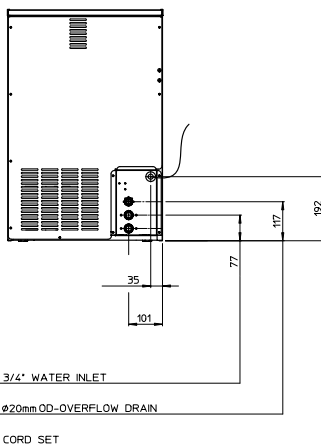
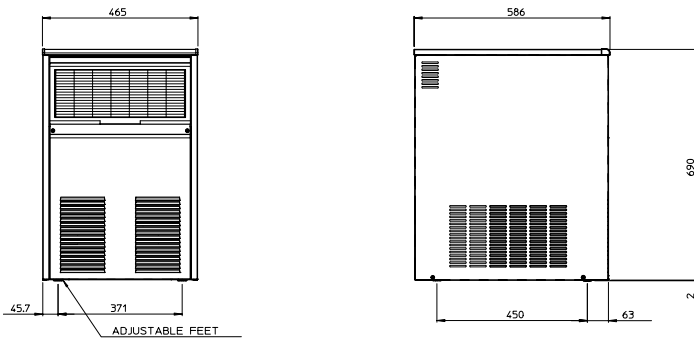

#### Ice production per 24 hours

Water temperature		32°	21°	15°	10°	
Ambient temperature	10°	24	26	27	28	kg
	21°	23	25	26	27	kg
	32°	18	20	21	22	kg
	38°	14	16	17	18	kg

### JET30M | JET30S

#### Dimensions

Width: 465mm  
Height: 690mm  
Depth: 586mm  
Nett weight: 37kg  
Packed weight: 44kg

#### Ice cube production dimension

Medium ice: 35mm dia x H 31mm, 20g  
Small ice: 26mm dia x H 23mm, 8g

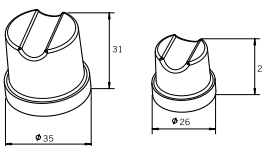

#### Water consumption

Air cooled version: 4 litres per hour

#### Electrical rating

Air cooled version: 220-240V, 1P+N+E, 50Hz, 310W, 10A cordset fitted

#### Refrigerant type

R134a

#### Installation distance from wall

- rear 150mm
- right 150mm
- left 150mm

Placement of unit should be indoors in an environment that does not exceed the air and water temperature limitations of the unit

#### Water connection requirements

Inlet connection: R 3/4"  
Cold water (5-35°C)  
Pressure (1-5 bar)  
Water outlet connection: Ø 20mm

**MOFFAT®**

moffat.com.au  
moffat.co.nz

Australia  
Moffat Pty Limited

Victoria/Tasmania  
740 Springvale Road  
Mulgrave, Victoria 3170  
Telephone 03-9518 3888  
Facsimile 03-9518 3833  
vsales@moffat.com.au

New South Wales  
Telephone 02-8833 4111  
nswsales@moffat.com.au

South Australia  
Telephone 03-9518 3888  
vsales@moffat.com.au

Queensland  
Telephone 07-3630 8600  
qldsales@moffat.com.au

Western Australia  
Telephone 08-9202 6820  
bgarcia@moffat.com.au

New Zealand  
Moffat Limited

Christchurch  
16 Osborne Street  
Christchurch 8011  
Telephone 03-389 1007  
Facsimile 03-389 1276  
sales@moffat.co.nz

Auckland  
Telephone 09-574 3150  
sales@moffat.co.nz

Disclaimer:  
All unit capacities are based on subjective testing. Moffat accepts no liability for production values.



In line with policy to continually develop and improve its products, Moffat Limited reserves the right to change specifications and design without notice.

© Copyright Moffat Ltd  
Moffat 05.13



TECHNICAL SPECIFICATION SHEET FOR

## Icematic JET Line Ice Maker

**JET40M** Medium ice cubes 35mm dia x H 31mm, 20g

**JET40S** Small ice cubes 26mm dia x H 23mm, 8g



- Self contained medium sized ice cube machine with built-in storage bin
- **37kg** daily production rate
- **24** ice cubes per cycle
- **16kg** storage bin capacity
- Air cooled condensing unit
- Electromechanical controls
- Horizontal spray technology to produce pure, crystal clear ice cubes
- Bin sensor stops ice production when the bin is full
- Built-in Agion antimicrobial protection for better sanitation
- Stainless steel external body
- Insulated bin door and ice storage bin minimises air condensation and water formation on equipment surfaces
- Front ventilation for improved yield even in critical install requirements
- Moffat IM101000 single stage triple action filtration system, including head and brass fittings
- Includes ice scoop

Note: Ice production rate is measured with the water temperature at 10°C and an ambient temperature of 21°C.

TECHNICAL SPECIFICATION SHEET FOR

## Icematic JET Line Ice Maker JET40M | JET40S

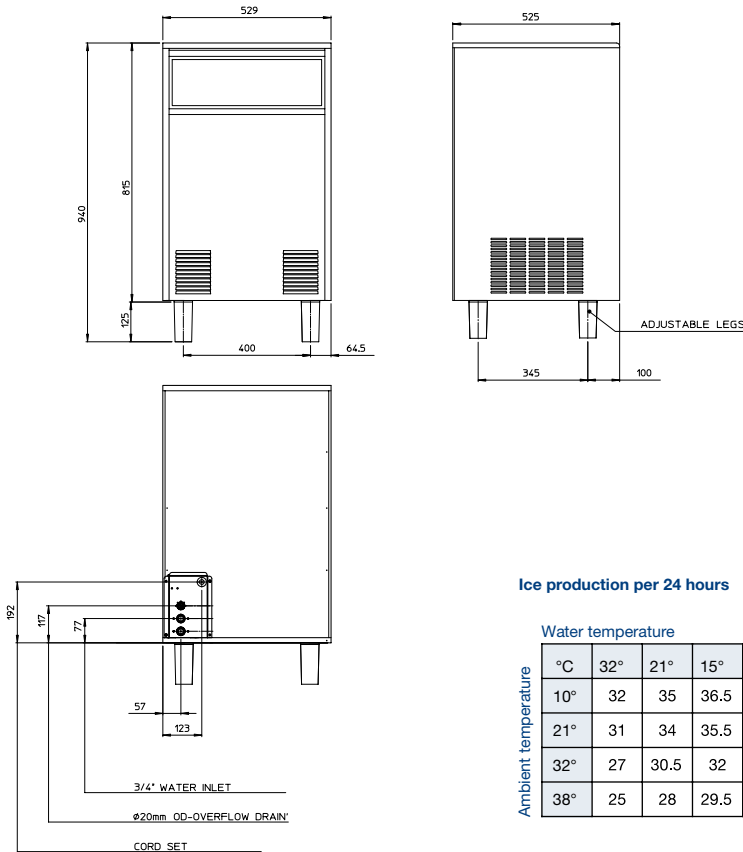

Ice production per 24 hours

		Water temperature					
		32°	21°	15°	10°		
Ambient temperature	10°	32	35	36.5	38	kg	
	21°	31	34	35.5	37	kg	
	32°	27	30.5	32	33	kg	
	38°	25	28	29.5	31	kg	

### JET40M | JET40S

#### Dimensions

Width: 529mm  
Height: 940mm (including legs)  
Depth: 525mm  
Nett weight: 41kg  
Packed weight: 48kg

#### Ice cube production dimension

Medium ice: Ø 35mm x H 31mm, 20g  
Small ice: Ø 26mm x H 23mm, 8g

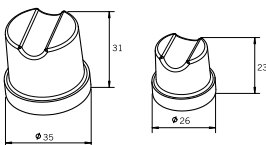

#### Water consumption

Air cooled version: 6 litres per hour

#### Electrical rating

Air cooled version: 220-240V, 1P+N+E, 50Hz, 500W, 10A cordset fitted

#### Refrigerant type

R134a

#### Installation distance from wall

- rear 150mm
- right 150mm
- left 150mm

Placement of unit should be indoors in an environment that does not exceed the air and water temperature limitations of the unit

#### Water connection requirements

Inlet connection: R 3/4"  
Cold water (5-35°C)  
Pressure (1-5 bar)  
Water outlet connection: Ø 20mm

**MOFFAT®**

moffat.com.au  
moffat.co.nz

Australia  
Moffat Pty Limited

Victoria/Tasmania  
740 Springvale Road  
Mulgrave, Victoria 3170  
Telephone 03-9518 3888  
Facsimile 03-9518 3833  
vsales@moffat.com.au

New South Wales  
Telephone 02-8833 4111  
nswsales@moffat.com.au

South Australia  
Telephone 03-9518 3888  
vsales@moffat.com.au

Queensland  
Telephone 07-3630 8600  
qldsales@moffat.com.au

Western Australia  
Telephone 08-9202 6820  
bgarcia@moffat.com.au

New Zealand  
Moffat Limited

Christchurch  
16 Osborne Street  
Christchurch 8011  
Telephone 03-389 1007  
Facsimile 03-389 1276  
sales@moffat.co.nz

Auckland  
Telephone 09-574 3150  
sales@moffat.co.nz

#### Disclaimer:

All unit capacities are based on subjective testing. Moffat accepts no liability for production values.



In line with policy to continually develop and improve its products, Moffat Limited reserves the right to change specifications and design without notice.

© Copyright Moffat Ltd  
Moffat 05.13



TECHNICAL SPECIFICATION SHEET FOR

## Icematic JET Line Ice Maker

**JET50M** Medium ice cubes 35mm dia x H 31mm, 20g



- Self contained medium sized ice cube machine with built-in storage bin
- **47.5kg** daily production rate
- **32** ice cubes per cycle
- **18kg** storage bin capacity
- Air cooled condensing unit
- Electromechanical controls
- Horizontal spray technology to produce pure, crystal clear ice cubes
- Bin sensor stops ice production when the bin is full
- Built-in Agion antimicrobial protection for better sanitation
- Stainless steel external body
- Insulated bin door and ice storage bin minimises air condensation and water formation on equipment surfaces
- Front ventilation for improved yield even in critical install requirements
- Moffat IM101000 single stage triple action filtration system, including head and brass fittings
- Includes ice scoop

Note: Ice production rate is measured with the water temperature at 10°C and an ambient temperature of 21°C.

TECHNICAL SPECIFICATION SHEET FOR

## Icematic JET Line Ice Maker JET50M

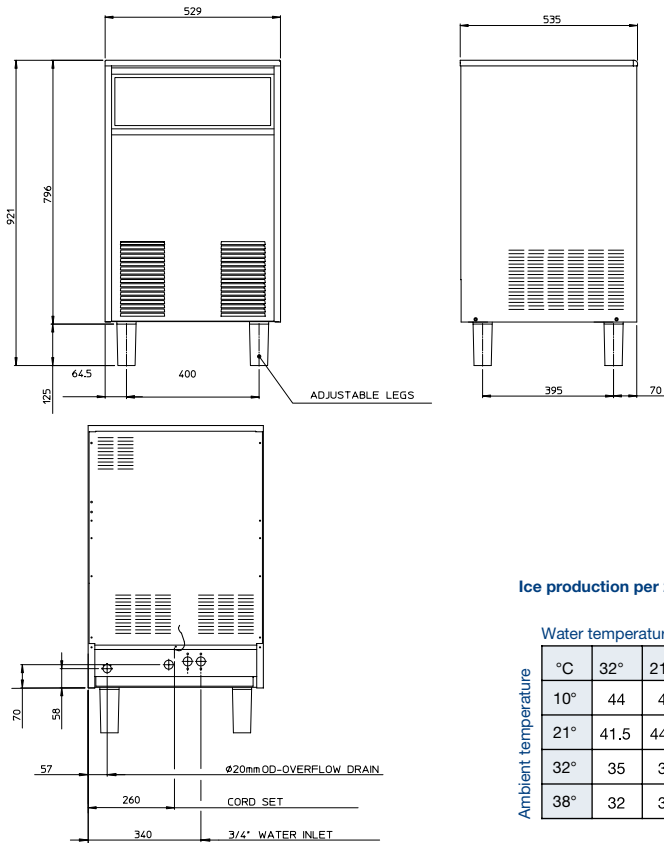

### Ice production per 24 hours

		Water temperature					
		32°	21°	15°	10°		
Ambient temperature	10°	44	47	48.5	50	kg	
	21°	41.5	44.5	46	47.5	kg	
	32°	35	38	39.5	41	kg	
	38°	32	35	36.5	38	kg	

### JET50M

#### Dimensions

Width: 529mm  
 Height: 921mm (including legs)  
 Depth: 535mm  
 Nett weight: 46kg  
 Packed weight: 54kg

#### Ice cube production dimension

Medium ice: Ø 35mm x H 31mm, 20g

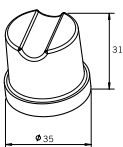

#### Water consumption

Air cooled version: 8 litres per hour

#### Electrical rating

Air cooled version: 220-240V, 1P+N+E, 50Hz, 550W, 10A cordset fitted

#### Refrigerant type

R134a

#### Installation distance from wall

- rear 150mm
- right 150mm
- left 150mm

Placement of unit should be indoors in an environment that does not exceed the air and water temperature limitations of the unit

#### Water connection requirements

Inlet connection: R 3/4"  
 Cold water (5-35°C)  
 Pressure (1-5 bar)  
 Water outlet connection: Ø 20mm

**MOFFAT®**

moffat.com.au  
 moffat.co.nz

Australia  
 Moffat Pty Limited  
 Victoria/Tasmania  
 740 Springvale Road  
 Mulgrave, Victoria 3170  
 Telephone 03-9518 3888  
 Facsimile 03-9518 3833  
 vsales@moffat.com.au

New South Wales  
 Telephone 02-8833 4111  
 nswsales@moffat.com.au

South Australia  
 Telephone 03-9518 3888  
 vsales@moffat.com.au

Queensland  
 Telephone 07-3630 8600  
 qldsales@moffat.com.au

Western Australia  
 Telephone 08-9202 6820  
 bgarcia@moffat.com.au

New Zealand  
 Moffat Limited

Christchurch  
 16 Osborne Street  
 Christchurch 8011  
 Telephone 03-389 1007  
 Facsimile 03-389 1276  
 sales@moffat.co.nz

Auckland  
 Telephone 09-574 3150  
 sales@moffat.co.nz

Disclaimer:  
 All unit capacities are based on subjective testing. Moffat accepts no liability for production values.



In line with policy to continually develop and improve its products, Moffat Limited reserves the right to change specifications and design without notice.

© Copyright Moffat Ltd  
 Moffat 05.13





TECHNICAL SPECIFICATION SHEET FOR

## Icematic JET Line Ice Maker

**JET70M** Medium ice cubes 35mm dia x H 31mm, 20g

**JET70S** Small ice cubes 26mm dia x H 23mm, 8g



- Self contained medium sized ice cube machine with built-in storage bin
- **67kg** daily production rate
- **48** ice cubes per cycle
- **30kg** storage bin capacity
- Air cooled condensing unit
- Electromechanical controls
- Horizontal spray technology to produce pure, crystal clear ice cubes
- Bin sensor stops ice production when the bin is full
- Built-in Agion antimicrobial protection for better sanitation
- Stainless steel external body
- Insulated bin door and ice storage bin minimises air condensation and water formation on equipment surfaces
- Front ventilation for improved yield even in critical install requirements
- Moffat IM101000 single stage triple action filtration system, including head and brass fittings
- Includes ice scoop

Note: Ice production rate is measured with the water temperature at 10°C and an ambient temperature of 21°C.

TECHNICAL SPECIFICATION SHEET FOR

## Icematic JET Line Ice Maker JET70M | JET70S

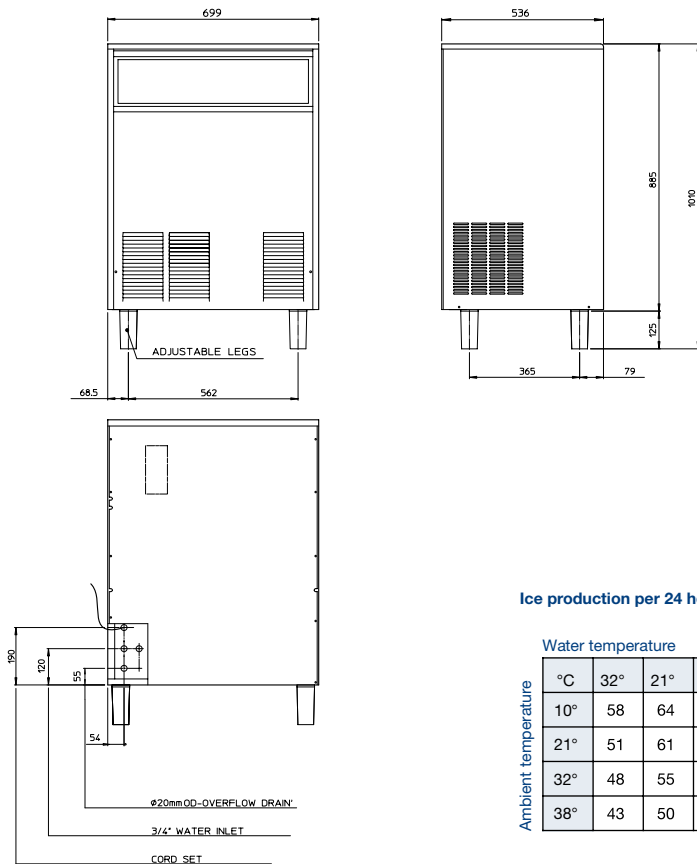

#### Ice production per 24 hours

		Water temperature				
		32°	21°	15°	10°	
Ambient temperature	10°	58	64	67	70	kg
	21°	51	61	64	67	kg
	32°	48	55	58	61	kg
	38°	43	50	53	56	kg

### JET70M | JET70S

#### Dimensions

Width: 699mm  
Height: 1010mm (including legs)  
Depth: 536mm  
Nett weight: 53kg  
Packed weight: 66kg

#### Ice cube production dimension

Medium ice: Ø 35mm x H 31mm, 20g  
Small ice: Ø 26mm x H 23mm, 8g

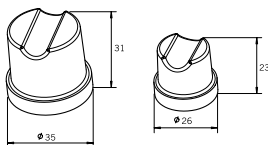

#### Water consumption

Air cooled version: 7 litres per hour

#### Electrical rating

Air cooled version: 220-240V, 1P+N+E, 50Hz, 670W, 10A cordset fitted

#### Refrigerant type

R134a

#### Installation distance from wall

- rear 150mm
- right 150mm
- left 150mm

Placement of unit should be indoors in an environment that does not exceed the air and water temperature limitations of the unit

#### Water connection requirements

Inlet connection: R 3/4"  
Cold water (5-35°C)  
Pressure (1-5 bar)  
Water outlet connection: Ø 20mm



moffat.com.au  
moffat.co.nz

Australia  
Moffat Pty Limited  
Victoria/Tasmania  
740 Springvale Road  
Mulgrave, Victoria 3170  
Telephone 03-9518 3888  
Facsimile 03-9518 3833  
vsales@moffat.com.au

New South Wales  
Telephone 02-8833 4111  
nswsales@moffat.com.au

South Australia  
Telephone 03-9518 3888  
vsales@moffat.com.au

Queensland  
Telephone 07-3630 8600  
qldsales@moffat.com.au

Western Australia  
Telephone 08-9202 6820  
bgarcia@moffat.com.au

New Zealand  
Moffat Limited

Christchurch  
16 Osborne Street  
Christchurch 8011  
Telephone 03-389 1007  
Facsimile 03-389 1276  
sales@moffat.co.nz

Auckland  
Telephone 09-574 3150  
sales@moffat.co.nz

Disclaimer:  
All unit capacities are based on subjective testing. Moffat accepts no liability for production values.



In line with policy to continually develop and improve its products, Moffat Limited reserves the right to change specifications and design without notice.

© Copyright Moffat Ltd  
Moffat 05.13



TECHNICAL SPECIFICATION SHEET FOR

## Icematic JET Line Ice Maker

**JET90M** Medium ice cubes 35mm dia x H 31mm, 20g

**JET90S** Small ice cubes 26mm dia x H 23mm, 8g



- Self contained medium sized ice cube machine with built-in storage bin
- **81kg** daily production rate
- **48** ice cubes per cycle
- **30kg** storage bin capacity
- Air cooled condensing unit
- Electromechanical controls
- Horizontal spray technology to produce pure, crystal clear ice cubes
- Bin sensor stops ice production when the bin is full
- Built-in Agion antimicrobial protection for better sanitation
- Stainless steel external body
- Insulated bin door and ice storage bin minimises air condensation and water formation on equipment surfaces
- Front ventilation for improved yield even in critical install requirements
- Moffat IM101000 single stage triple action filtration system, including head and brass fittings
- Includes ice scoop

Note: Ice production rate is measured with the water temperature at 10°C and an ambient temperature of 21°C.

TECHNICAL SPECIFICATION SHEET FOR

## Icematic JET Line Ice Maker JET90M | JET90S

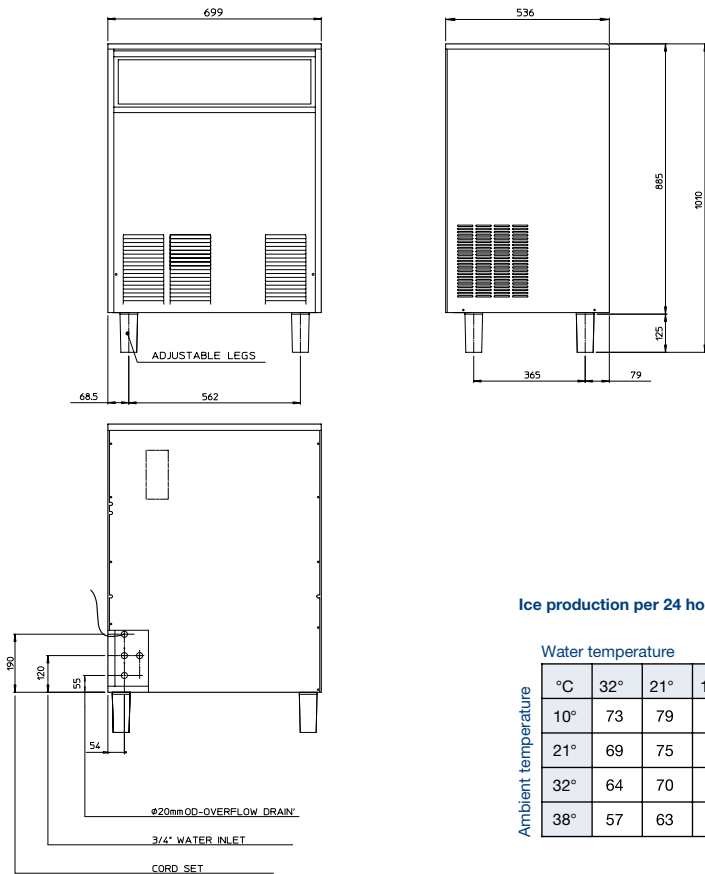

#### Ice production per 24 hours

		Water temperature				
		32°	21°	15°	10°	
Ambient temperature	10°	73	79	82	85	kg
	21°	69	75	78	81	kg
	32°	64	70	73	76	kg
	38°	57	63	66	69	kg

### JET90M | JET90S

#### Dimensions

Width: 699mm  
Height: 1010mm (including legs)  
Depth: 536mm  
Nett weight: 65kg  
Packed weight: 78kg

#### Ice cube production dimension

Medium ice: Ø 35mm x H 31mm, 20g  
Small ice: Ø 26mm x H 23mm, 8g

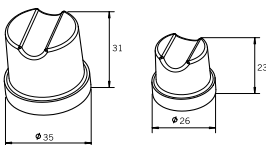

#### Water consumption

Air cooled version: 11 litres per hour

#### Electrical rating

Air cooled version: 220-240V, 1P+N+E, 50Hz, 830W, 10A cordset fitted

#### Refrigerant type

R134a

#### Installation distance from wall

- rear 150mm
- right 150mm
- left 150mm

Placement of unit should be indoors in an environment that does not exceed the air and water temperature limitations of the unit

#### Water connection requirements

Inlet connection: R ¾"  
Cold water (5-35°C)  
Pressure (1-5 bar)  
Water outlet connection: Ø 20mm

**MOFFAT®**

moffat.com.au  
moffat.co.nz

Australia  
Moffat Pty Limited  
Victoria/Tasmania  
740 Springvale Road  
Mulgrave, Victoria 3170  
Telephone 03-9518 3888  
Facsimile 03-9518 3833  
vsales@moffat.com.au

New South Wales  
Telephone 02-8833 4111  
nswsales@moffat.com.au

South Australia  
Telephone 03-9518 3888  
vsales@moffat.com.au

Queensland  
Telephone 07-3630 8600  
qldsales@moffat.com.au

Western Australia  
Telephone 08-9202 6820  
bgarcia@moffat.com.au

New Zealand  
Moffat Limited

Christchurch  
16 Osborne Street  
Christchurch 8011  
Telephone 03-389 1007  
Facsimile 03-389 1276  
sales@moffat.co.nz

Auckland  
Telephone 09-574 3150  
sales@moffat.co.nz

Disclaimer:  
All unit capacities are based on subjective testing. Moffat accepts no liability for production values.



In line with policy to continually develop and improve its products, Moffat Limited reserves the right to change specifications and design without notice.

© Copyright Moffat Ltd  
Moffat 05.13

